

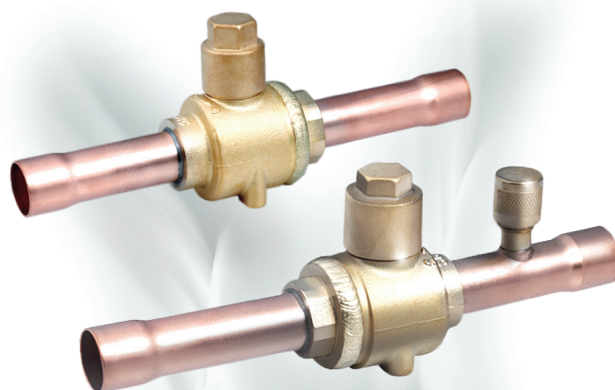

Ball Valve

The ball valve of series SBV is applicable for commercial air conditioner, freezing or deep-freezing equipment or other refrigeration circuits in order to open and to shut off inner flow path by operating the valve stem. It can also be used as service valve for vacuum pumping and refrigerant injection etc.



FEATURES

- STRAIGHTWAY TYPE, FULL PORT, LOW PRESSURE DROP , COST-EFFECTIVE
- OPTIONAL WITH REINFORCED SPRING
- VALVE BODY AND VALVE SEAT WITH WELDED STRUCTURE, WITH HIGH PRODUCT RELIABILITY
- ROTATE 1/4 CIRCLES FROM FULL-OPEN TO FULL-CLOSE, EASY TO OPERATE
- BIDIRECTIONAL FLOW
- ROTATION STOP ON REQUEST FOR FULL-OPEN AND FULL-CLOSE OF THE VALVE
- SPECIAL SEALING MATERIALS TO PREVENT INTERNAL LEAKAGE

GENERAL SPECIFICATIONS

- Applicable for all common HCFC and HFC refrigerants such as: R22, R134a, R404A, R407C, R410A, R507A ...
- Medium temperature TS min./max.: -40°C / +120°C
- Max. operating pressure PS: 4,5 MPa (45 bar)
- Installation position: liquid, suction and discharge line in all directions
- Certifications: UL/CSA and PED declaration



SANHUA SBV SERIES Ball Valve

GENERAL CHARACTERISTICS

| Without Access Fitting | | Connections Ø d ODF | | Kv | Wrench Size Cap | PED category | With Access Fitting | |
|------------------------|----------------|---------------------------|------|--------|-----------------------|-----------------|---------------------|----------------|
| Model | Part Number | [inch] | [mm] | [m³/h] | [mm] | | Model | Part Number |
| SBV(M)-A2YHSY-2-S | SBV-13001 | - | 6 | 1,9 | 14 | 3.3 | SBV(M)-JA2YHSY-2-S | SBV-13019 |
| SBV(M)-A2YHSY-1-S | SBV-13002 | 1/4 | - | 1,9 | 14 | 3.3 | SBV(M)-JA2YHSY-1-S | SBV-13020 |
| SBV(M)-A3YHSY-2-S | SBV-13037 | 3/8 | - | 5,5 | 14 | 3.3 | SBV(M)-JA3YHSY-2-S | SBV-13039 |
| SBV(M)-A3YHSY-1-S | SBV-13003 | - | 10 | 5,5 | 14 | 3.3 | SBV(M)-JA3YHSY-1-S | SBV-13021 |
| SBV(M)-A4YHSY-2-S | SBV-13004 | - | 12 | 10,2 | 14 | 3.3 | SBV(M)-JA4YHSY-2-S | SBV-13022 |
| SBV(M)-A4YHSY-1-S | SBV-13005 | 1/2 | - | 10,2 | 14 | 3.3 | SBV(M)-JA4YHSY-1-S | SBV-13023 |
| SBV(M)-A5YHSY-2-S | SBV-13006 | - | 15 | 13,2 | 14 | 3.3 | SBV(M)-JA5YHSY-2-S | SBV-13024 |
| SBV(M)-A5YHSY-1-S | SBV-13007 | 5/8 | 16 | 13,8 | 14 | 3.3 | SBV(M)-JA5YHSY-1-S | SBV-13025 |
| SBV(M)-A6YHSY-2-S | SBV-13008 | - | 18 | 19,5 | 17 | 3.3 | SBV(M)-JA6YHSY-2-S | SBV-13026 |
| SBV(M)-A6YHSY-1-S | SBV-13009 | 3/4 | - | 19,5 | 17 | 3.3 | SBV(M)-JA6YHSY-1-S | SBV-13027 |
| SBV(M)-A7YHSY-1-S | SBV-13010 | 7/8 | 22 | 28,0 | 17 | 3.3 | SBV(M)-JA7YHSY-1-S | SBV-13028 |
| SBV(M)-A9YHSY-2-S | SBV-13011 | - | 28 | 51,5 | 17 | 3.3 | SBV(M)-JA9YHSY-2-S | SBV-13029 |
| SBV(M)-A9YHSY-1-S | SBV-13012 | 1 1/8 | - | 51,5 | 17 | 3.3 | SBV(M)-JA9YHSY-1-S | SBV-13030 |
| SBV(M)-A11YHSY-1-S | SBV-13013 | 1 3/8 | 35 | 80,0 | 17 | I | SBV(M)-JA11YHSY-1-S | SBV-13031 |
| SBV(M)-A13YHSY-2-S | SBV-13038 | 1 5/8 | - | 119,8 | 17 | I | SBV(M)-JA13YHSY-2-S | SBV-13040 |
| SBV(M)-A13YHSY-1-S | SBV-13014 | - | 42 | 119,8 | 17 | I | SBV(M)-JA13YHSY-1-S | SBV-13032 |
| SBV(M)-A17YHSY-1-S | SBV-13015 | 2 1/8 | 54 | 225 | 19 | I | SBV(M)-JA17YHSY-1-S | SBV-13033 |
| SBV(M)-A19YHSY-1-S | SBV-13016 | - | 64 | 225 | 19 | I | SBV(M)-JA19YHSY-1-S | SBV-13034 |
| SBV(M)-A21YHSY-2-S | SBV-13017 | 2 5/8 | - | 305 | 19 | I | SBV(M)-JA21YHSY-2-S | SBV-13035 |
| SBV(M)-A25YHSY-2-S | SBV-13018 | 3 1/8 | 80 | 635 | 24 | I | SBV(M)-JA25YHSY-2-S | SBV-13036 |
| SBV(M)-A29YHSY-1-S | SBV-13041 | 3 5/8 | 92 | 805 | 26 | I | SBV(M)-JA29YHSY-1-S | SBV-13043 |
| SBV(M)-A33YHSY-2-S | SBV-13046 | 4 1/8 | 105 | 950 | 32 | I | SBV(M)-JA33YHSY-2-S | SBV-13045 |
| SBV(M)-A34YHSY-1-S | SBV-13042 | 4 1/4 | 108 | 950 | 32 | I | SBV(M)-JA34YHSY-1-S | SBV-13044 |

Note: SBV model with connection size 3-1/2" (89mm) available on request





SANHUA SBV SERIES Ball Valve

DIMENSIONS

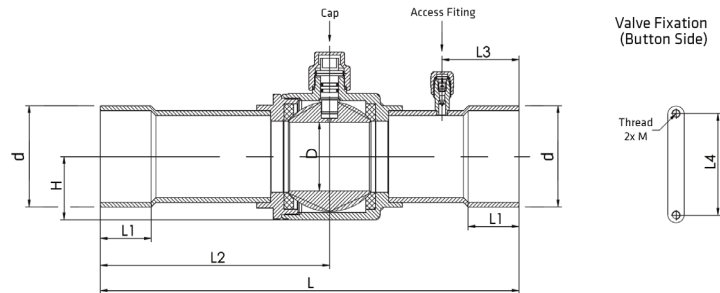

| Part Number | | L | L1 | L2 | L3 ¹⁾ | L4 | D | H | M | Weight |
|------------------------|---------------------|-------|------|-------|------------------|------|------|------|----------|--------|
| Without access fitting | With Access Fitting | [mm] | [mm] | [mm] | [mm] | [mm] | [mm] | [mm] | [mm] | [kg] |
| SBV-13001 | SBV-13019 | 132 | 8 | 68 | 31 | 22 | 14 | 16 | M4 x 0,7 | 0,28 |
| SBV-13002 | SBV-13020 | 132 | 8 | 68 | 31 | 22 | 14 | 16 | M4 x 0,7 | 0,28 |
| SBV-13037 | SBV-13039 | 132 | 8 | 68 | 31 | 22 | 14 | 16 | M4 x 0,7 | 0,29 |
| SBV-13003 | SBV-13021 | 132 | 8 | 68 | 31 | 22 | 14 | 16 | M4 x 0,7 | 0,29 |
| SBV-13004 | SBV-13022 | 160 | 10 | 85 | 31 | 22 | 14 | 16 | M4 x 0,7 | 0,30 |
| SBV-13005 | SBV-13023 | 160 | 10 | 85 | 31 | 22 | 14 | 16 | M4 x 0,7 | 0,30 |
| SBV-13006 | SBV-13024 | 160 | 12 | 85 | 31 | 22 | 14 | 16 | M4 x 0,7 | 0,30 |
| SBV-13007 | SBV-13025 | 160 | 12 | 85 | 31 | 22 | 14 | 16 | M4 x 0,7 | 0,30 |
| SBV-13008 | SBV-13026 | 185 | 14 | 99 | 37 | 30 | 19 | 20 | M4 x 0,7 | 0,51 |
| SBV-13009 | SBV-13027 | 185 | 14 | 99 | 37 | 30 | 19 | 20 | M4 x 0,7 | 0,51 |
| SBV-13010 | SBV-13028 | 185 | 17 | 99 | 37 | 30 | 19 | 20 | M4 x 0,7 | 0,52 |
| SBV-13011 | SBV-13029 | 208 | 20 | 112 | 44 | 38 | 25 | 25 | M4 x 0,7 | 0,73 |
| SBV-13012 | SBV-13030 | 208 | 20 | 112 | 44 | 38 | 25 | 25 | M4 x 0,7 | 0,73 |
| SBV-13013 | SBV-13031 | 251 | 25 | 136 | 44 | 48 | 32 | 31 | M6 x 1,0 | 1,42 |
| SBV-13038 | SBV-13040 | 281 | 29 | 151 | 56 | 55 | 38 | 35 | M6 x 1,0 | 1,90 |
| SBV-13014 | SBV-13032 | 281 | 29 | 151 | 56 | 55 | 38 | 35 | M6 x 1,0 | 1,90 |
| SBV-13015 | SBV-13033 | 305 | 34 | 167 | 56 | 74 | 50 | 46 | M6 x 1,0 | 3,74 |
| SBV-13016 | SBV-13034 | 305 | 34 | 167 | 70 | 74 | 50 | 46 | M6 x 1,0 | 3,79 |
| SBV-13017 | SBV-13035 | 305 | 37 | 167 | 56 | 74 | 60 | 56 | M6 x 1,0 | 6,08 |
| SBV-13018 | SBV-13036 | 378 | 42 | 186,2 | 80 | 90 | 70 | 63 | M6 x 1,0 | 8,81 |
| SBV-13041 | SBV-13043 | 422,7 | 42 | 207,5 | 75 | 108 | 80 | 75 | M6 x 1,0 | 11,32 |
| SBV-13046 | SBV-13045 | 423 | 42 | 210,0 | 75 | 148 | 95 | 91 | M6 x 1,0 | 19,94 |
| SBV-13042 | SBV-13044 | 423 | 42 | 210,0 | 75 | 148 | 95 | 91 | M6 x 1,0 | 19,94 |

Note: 1) Applicable to versions with access fitting - SBV(M)-JA series

